



# *507N Landing Collar System*

Weatherford's field-proven, modular 507N landing collar system can be customized for specific applications. The system is compatible with accessories of the Weatherford landing collar (WLC) system and includes an integrated 45-degree sloped landing surface that accommodates Weatherford WiperLok® nonrotating cementing plugs.

The 507N body is manufactured box × pin and accommodates a threaded aluminum tube that is cemented in place and designed to accept customized aluminum accessories such as catcher tubes, catcher-tube caps, and ball seats, all of which must be ordered separately.

## *Applications*

- Weatherford Sub-Surface Release™ mid-bore and large-bore plug systems with *Wiperlok* nonrotating profiles requiring a high-pressure landing system
- Hydraulic liner systems requiring ball-seat accessories

## *Features, Advantages and Benefits*

- Castellations molded into the concrete landing surface prevent cementing plugs from spinning during drillout, providing significantly faster drillout times.
- The system's compatible accessories can be installed in the field for operational flexibility.
- When required, the optional catcher tube is made up into the threaded aluminum tube.
- The redesigned ball-seat shear ring provides reliable liner setting pressures, providing a simple and reliable operation.
- The 507N assembly is polycrystalline-diamond-composite (PDC) drillable, minimizing complications during drillout and thereby conserving rig time.
- The 45-degree sloped molded concrete landing surface serves as a ball guide to ensure that the ball reaches the seat.

## *Specifications*

- The 507N system is available in sizes 8-5/8 in. (219.1 mm) and larger.

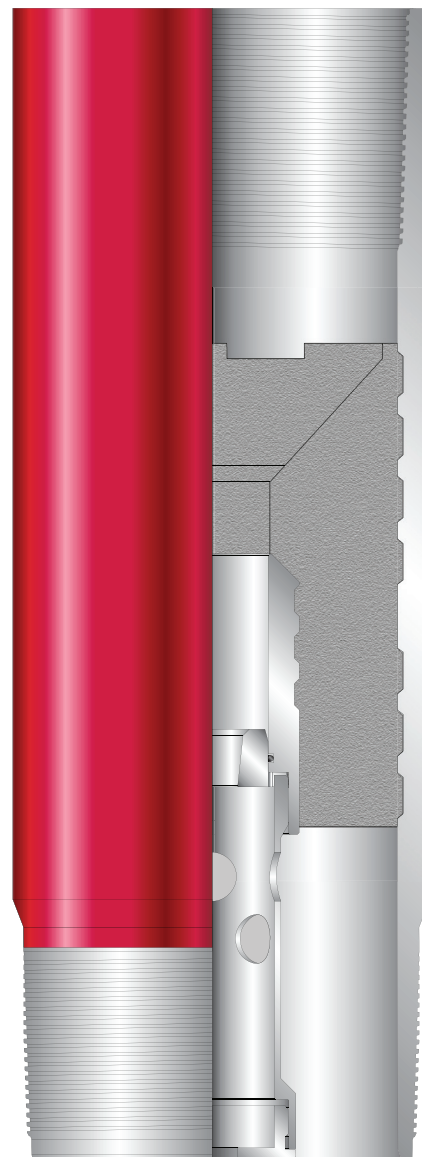

## 507N Landing Collar System

### Options

- Multiple threads and metallurgies are available as required.
- Each body can accommodate an optional catcher tube and tube cap with or without a ball seat, depending on the application.

### Catcher Tube (Optional)

The optional catcher tube screws into the bottom of the aluminum tube and catches balls, ball seats, or darts. Catcher tubes have matching box × pin connections so that they can be screwed together for a longer tube assembly.

### Catcher Cap (Optional)

The optional catcher cap threads onto the bottom end of the catcher tube to capture anything in the tube. One cap is required for each catcher tube. If multiple catcher tubes are ordered to increase length, only one cap is required at the bottom.

### Ball Seat (Optional)

The optional ball seat is located below the WiperLok® profile and is held in place with a catcher tube. Ball seats can catch 1 1/2-in. (38.1 mm), 1 3/4-in. (44.5 mm) or 2-in. (50.8 mm) balls, which are available for three different shear pressures and are color-coded for easy identification. For special applications, a 5,000-psi shear pressure ball seat is available with a black color code.



Standard cap



Pass-through cap

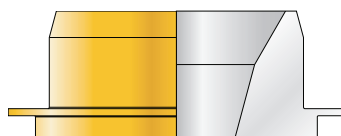

2,500 psi  
17.23 MPa



3,000 psi  
20.68 MPa

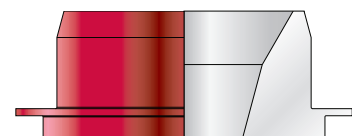

3,500 psi  
24.13 MPa