



WLC Landing Collar System

Weatherford's WLC landing collar system is modular. The body is manufactured box × pin and incorporates a threaded aluminum tube that is cemented in place to accept components that customize it for specific plug types and applications. Aluminum accessory components (such as catcher tubes, catcher tube caps, and ball seats) are ordered separately and screw into the tube to customize the assembly.

The WLC body comes with a plug-catcher insert that is compatible with one of four different plug types and their respective nose profiles. The plug types drive the model designations of the landing collar. Single-plug configurations are WLCS (SWP), WLCL (LWP), and WLCF (FLWP). The dual-plug configuration is WLCD (sub-surface release™ small-bore {SSRSB}). (See Plug and Catcher Insert chart for specific plug availability by size.)

Each plug lands and latches into its respective catcher insert with antirotation profile. All components are compatible with PDC drillbits, and aluminum content in the assembly is minimized to promote faster drillout.

Applications

- For use with liner sizes 4-1/2 to 5-1/2 in. and 7 to 7-5/8 in.
- Compatible with all standard Weatherford liner-wiper plugs: SWP, LWP, FLWP, and SSRSB

Features, Advantages and Benefits

- The system's accessory components can be installed in the field.
- Several features help simplify or accelerate drillout, saving rig time:
 - All plugs latch in place and have antirotation profiles.
 - The WLC assemblies and plugs are compatible with PDC drillbits to provide operational flexibility.
 - The threaded aluminum tube is cemented in the body, minimizing aluminum content.

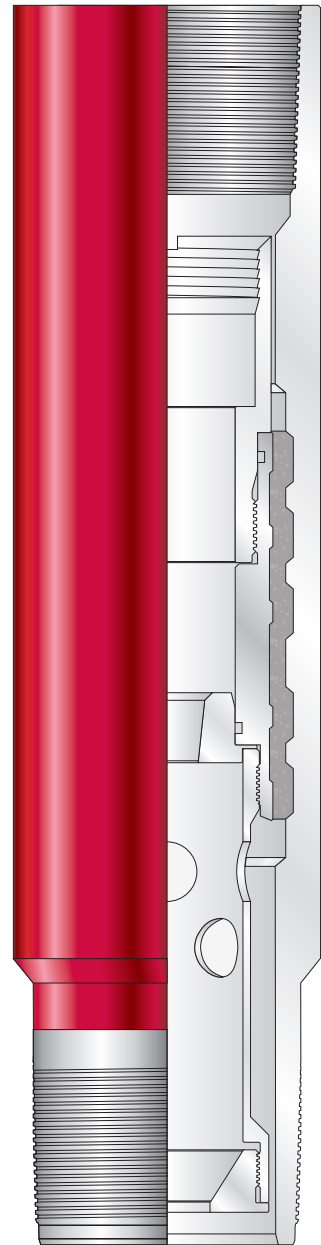



WLC Landing Collar System

Options

- Each body can accommodate the appropriate plug-catcher insert, with or without catcher tube, tube cap, and ball seat, depending on the application.
- Threads and metallurgies are available, as required.

Plug-Catcher Inserts

The insert screws into the top of the aluminum tube and incorporates the landing shoulder and the antirotation profile for the chosen plug.

Plug and Catcher Insert Availability

Catcher Size ^a (in./mm)	Liner Wiper Plugs			
	Single Configuration			Dual Configuration
	SWP	LWP	FLWP	
4.500 114.3	X	X	X	
5.000 127.0	X	X	X	
5.500 139.7	X	X	X	
7.000 177.8	X	X		X
7.625 193.7	X	X		X

^a Choose the catcher insert that goes with the corresponding plug for the required application.

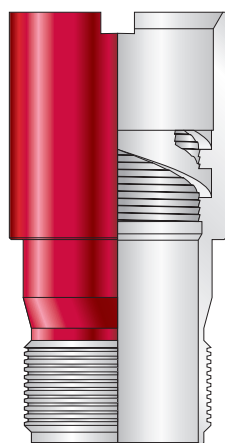

SWP
(WLCS)

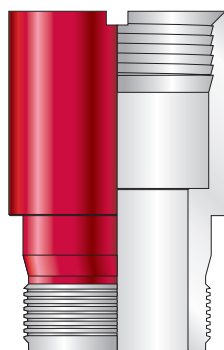

LWP
(WLCL)

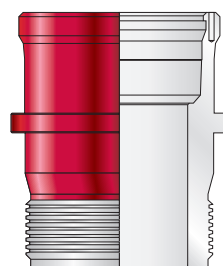

SSRSB
(WLCD)

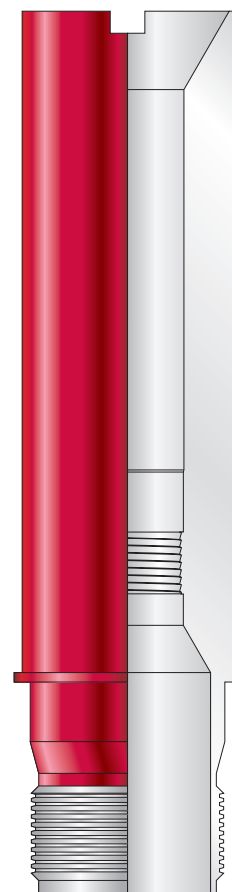

FLWP
(WLCF)

WLC Landing Collar System

Catcher Tube (Optional)

This optional accessory is screwed into the bottom of the aluminum tube and is used for catching balls, ball seats, or darts. Catcher tubes have matching box and pin connections so they can be screwed together for a longer tube, if needed.

Catcher Cap (Optional)

This cap threads onto the bottom end of the catcher tube to capture anything in the tube. If multiple catcher tubes are ordered to increase length, only one cap is required at the bottom. The WLC pass-through tube cap allows autofill and drillshoe conversion balls, as well as setting balls, to pass through the cap.

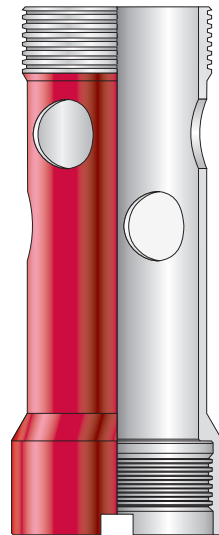

Catcher tube



Standard cap

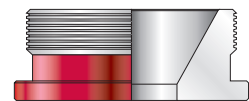

Pass-through cap

Ball Seat (Optional)

The ball seat is located below the plug-catcher insert and is held in place with a catcher tube. The ball seat accommodates a 1 1/4-in. (31.75-mm) diameter ball in the 4 1/2-in. to 5 1/2-in. (114.3- to 139.7-mm) size and a 1-3/4 diameter ball in the 7 to 7-5/8 size. Ball seats are available in three different shear-pressure ratings that are color coded for easy identification: yellow (2,500 psi/17.23 MPa), green (3,000 psi/20.68 MPa), and red (3,500 psi/24.13 MPa).

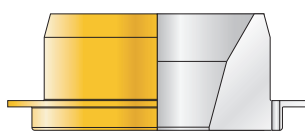

2,500 psi (17.23 MPa)

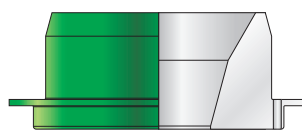

3,000 psi (20.68 MPa)

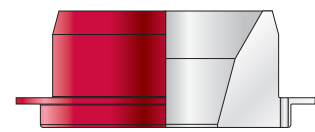

3,500 psi (24.13 MPa)