



RapidFlo™ Plunger

Weatherford's new *RapidFlo* plunger is designed specifically to excel in wells producing near-critical flow rates. This application requires a robust, durable product capable of withstanding high impacts at the surface and downhole while maintaining efficient sealing during upward travel. This design also enables the *RapidFlo* plunger to fall against high flow rates while falling to the end of the production tubing to start the next cycle. Computational Fluid Dynamics (CFD) analysis was instrumental in the design process before successfully field-testing prototypes.

Applications

- Ideal for wells that require little to no shut-in or pressure-buildup time

Features, Advantages and Benefits

- Durable design and materials improve performance in high-velocity wells, decreasing run time and operational expenditures.
- Aerodynamic design and maximum flow areas prompt greater fall speeds and the ability to fall against high gas rates, increasing the number of cycles, production, and revenue.
- The astralloy dart is resistant to impact damage, improving overall run life while reducing costs.
- A spiral or brush sealing element enables a design choice for wells with or without some sand production, improving operational flexibility by including additional applications in wells making a limited amount of sand.

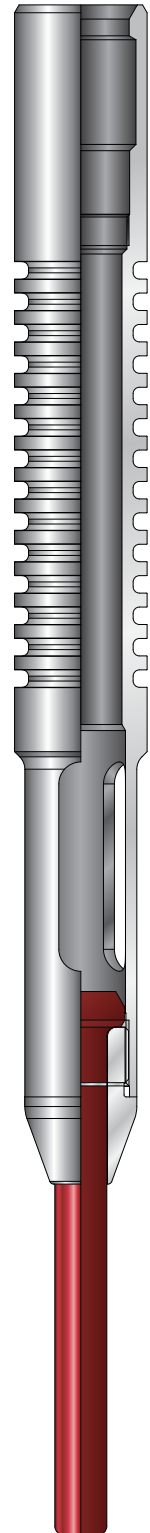



RapidFlo™ Plunger

Specifications

Tubing OD (in./mm)	Pipe ID (in./mm)	Plunger OD (in./mm)	Fishneck ID (in./mm)	Plunger Bypass Area (in. ² /mm ²)	Fishing Tool
2-1/16 52.38	1.751 44.475	1.640 41.656	7/8 22.22	0.894 576.77	1 3/4-in. GS
2-3/8 60.32	1.995 50.673	1.890 48.006	1-3/8 34.92	1.314 847.74	2-in. GS
2-7/8 73.02	2.441 62.001	2.340 59.436		1.853 1195.48	

Options

This plunger is available with a spiral or brush sealing body/element.